

Barry Stoodley Pty Ltd



COUPLINGS

Rigid Mount Duplex Pintle Hook 50mm Diameter Ball

Forged alloy steel and heat treated throughout for toughness, strength, and durable operation.

A special rigid mount duplex pintle hook that combines a pintle hook and ball hitch. Designed for customers who need the strength and capacity to pull trailers equipped with drawbars, as well as the flexibility to pull trailers with ball hitches. Tested in accordance with SAE J847 (Type II) and ADR 62/01. Meets J684 Class 4 standard for a 2" (50.4 mm) ball.

NOTE: For off-road applications, reduce the stated capacities by 25% and use with a swivel-mount drawbar.

Lighter weight yet stronger than the competitor's offering.

The secondary lock is a "D" ring for added safety.



50mm ball is permanently attached. It cannot be stolen or misplaced.

Our unique design is stronger and more durable than a removable ball design. The special shape eliminates premature wear typically caused by the drawbar pulling against the ball. Provides better oscillation or articulation in off-road conditions than a removable ball hitch.

Part Number	Length	Weight	Maximum Vertical Load	*Maximum Gross Trailer Weight	D-Rating kN	CRN Number
PH16B	165.1 mm	4.5 kg	1,724 kg	8,618 kg	20 kN	25767

IMPORTANT: *Maximum Gross Trailer Weight for the 50 mm Ball is 4,536 kg (10,000 lbs).

Drawbar Eye Dimensions: 60.4 mm to 76.2 mm I.D. with 31.7 mm to 41.4 mm diameter section.

Rigid Mount Pintle Hook

Forged alloy steel and heat treated throughout for toughness, strength, and durable operation.

A versatile rigid mount pintle hook designed for over-the road and off-road towing within stated capacities.

Tested in accordance with SAE J847 (Type II) and ADR 62/01.

NOTE: For off-road applications, reduce the stated capacities by 25% and use with a swivel-mount drawbar.

A chain and cotter pin are the secondary lock.

Surfaces are machined to tight tolerances to ensure durability.

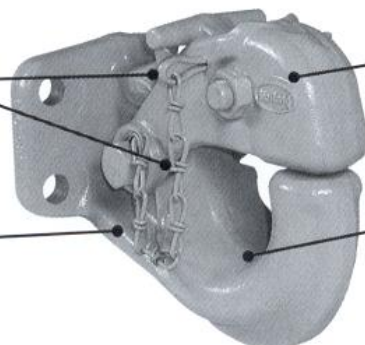

The latch is forged alloy steel and heat treated for strength and long life.

The special pintle body shape is designed for maximum articulation or oscillation and reduced wear.

Part Number	Length	Weight	Maximum Vertical Load	Maximum Gross Trailer Weight	D-Rating kN	CRN Number
PHT60AOL8	159.7 mm	5 kg	2,722 kg	13,608 kg	35	26465

IMPORTANT: Drawbar Eye Dimensions: 50.8 mm to 76.2 mm I.D. with 31.7 mm to 41.4 mm diameter section.

NOTE: Specifications regarding measurements and weights are nominal only. We reserve the right to make changes as necessary.

Barry Stoodley Pty Ltd



COUPLINGS

Rigid Mount Pintle Hook With Air Cushioned Snubber

A rigid mount pintle hook designed for trailers, semitrailers, and double operations. Used for off- and over-the-road applications, with an air cushioned snubber, designed to minimize the space between the pintle hook and the drawbar and helps provide some shock absorption. This pintle hook is recommended for severe duty applications. Tested in accordance with SAE J847 (Type II) and ADR 62/01.

NOTE: For off-road applications, reduce the stated capacities by 25% and use with a swivel-mount drawbar.



Part Number	Length	Weight	Maximum Vertical Load	Maximum Gross Trailer Weight	D-Rating kN	CRN Number
PH300	*184.1 mm	19 kg	8,165 kg	32,659 kg	165	24295
PH3001	184.1 mm	13 kg	8,165 kg	32,659 kg	165	24295

IMPORTANT: *Length Dimension is external to mounting structure. The added measurement is 146.3 mm. Drawbar Eye Dimensions: 60.4 mm to 76.2 mm I.D. with 31.7 mm to 41.4 mm diameter section. The complete assembly includes a pintle body, plunger, air chamber, and mounting brackets. For pintle hooks without an air chamber, bracket, or plunger, order PH3001. The PH300 can be operated with or without the air chamber.

Swivel Mount Pintle Hook

Forged alloy steel and heat treated throughout for toughness, strength, and durable operation. Extreme duty construction, logging, milk hauling primarily off-road applications provides torsional relief where a significant amount of articulation is required in a swivel-type mount pintle hook.

NOTE: For off-road applications, reduce the stated capacities by 25% and use with a non-swivel mount drawbar.



Part Number	Length	Weight	Maximum Vertical Load	Maximum Gross Trailer Weight	D-Rating kN	CRN Number
PH775E	*214.4 mm	25 kg	9,072 kg	45,360 kg	N/A	N/A

IMPORTANT: *Length Dimension is external to mounting structure. The added measurement is 167.7 mm. Drawbar Eye Dimensions: 76.2 mm I.D. with a 41.4 mm diameter section.

NOTE: Specifications regarding measurements and weights are nominal only. We reserve the right to make changes as necessary.

Barry Stoodley Pty Ltd

THE CHOICE CONNECTION

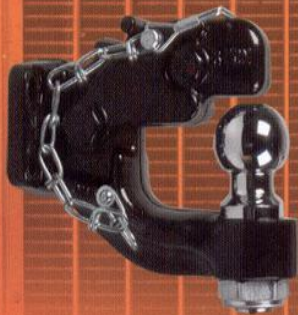

8 ton dual purpose hitch
with 50mm ball



45 ton air compensated pintle
hook compact assembly



45 ton towing eye 3 inch inside
dimension 4 bolt mounting



5 ton light duty pintle hook
c/w mounting kit



8 ton medium duty pintle hook
c/w mounting kit



15 ton heavy duty pintle hook
c/w mounting kit

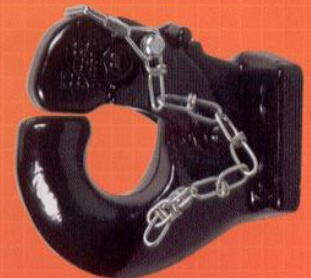

20 ton heavy duty pintle hook
c/w mounting kit

A leading supplier of advanced technology transport components, JOST Australia is now the exclusive distributor for the comprehensive range of Buyers Products.

Buyers Products was established in 1946 as a distributor of truck and trailer components, and has grown to become a leading manufacturer and supplier of a complete line of products for the mobile equipment industry.

Each product is designed to deliver safety, durability, efficiency and ease of operation with demanding testing standards maintaining JOST's worldwide reputation for excellence.

The products have also been tested here in Australia to comply with local requirements and Component Registration Numbers or CRNs have been obtained. These are available from your local JOST office or on our website.

OUR REPUTATION IS YOUR GUARANTEE

JOST
AUSTRALIA

Barry Stoodley Pty Ltd

BUYERS PINTLE HOOKS

PART NUMBER	DESCRIPTION	CRN #	D-VALUE	CAPACITY		WEIGHT
				M.V.L.	M.G.T.W.	
BPC BH 850 MM	8 ton combination pintle hook	37265	30kN	1361 kg/3000lbs	7257 kg/16,000lbs	5.9 kg/13lbs
BPC PH 5 WMK	5 ton light duty	37269	35kN	907 kg/2000lbs	4536 kg/10,000lbs	3.74 kg/8.25lbs
BPC PH 8 WMK	8 ton medium duty	37270	50kN	1451 kg/3200lbs	7257 kg/16,000lbs	4.34 kg/9.57lbs
BPC PH 15 WMK	15 ton heavy duty	37267	75kN	2722 kg/6000lbs	13608 kg/30,000lbs	5.33 kg/11.75lbs
BPC PH 20 WMK	20 ton heavy duty	37268	100kN	3629 kg/8000lbs	18144 kg/40,000lbs	6.03 kg/13.3lbs
BPC P45 AC4K	45 ton air compensated pintle hook complete assembly	37266	165kN	8165 kg/18,000lbs	40824 kg/90,000lbs	17.42 kg/38.4lbs
BPC 45 T24	Air chamber for use with BPC P45 AC4 pintle hook	NA	NA	NA	NA	4.17 kg/9.2lbs
BPC P 45 AC4 **	45 ton air compensated pintle hook only	37266	165kN	8165 kg/18,000wlbs	40824 kg/90,000lbs	11.79 kg/26lbs
BPC P 45 AC4BK**	Bracket only	NA	NA	NA	NA	1.45 kg/3.2lbs

** These products must be ordered together

BDB 1394	45 ton towing eye 3" inch I.D 4 x bolt mounting	37264	165kN	8618 kg/19,000lbs	40824 kg/90,000lbs	9.07 kg/20lbs
BPC PM 87	Pintle hook mount - 8 hole shank dimensions 2" x 9" suits PH5, PH8, PH15, PH20, & BH8	NA	NA	907 kg/2000lbs	4535 kg/10,000lbs	6.80 kg/15.0lbs

BUYERS LANDING LEGS

PART No:	DESCRIPTION	TRAVEL	WIND	CAPACITY	WEIGHT
BPC 0091205	Tube jack - swivel mount	254mm/10 inches	Top	907 kg/2000lbs	5.05 kg/11.14lbs
BPC 0091210	Tube jack - bracket swivel mount	254mm/10 inches	Top	907 kg/2000lbs	5.05 kg/11.14lbs
BPC 0091215	Tube jack - swivel mount	381mm/15 inches	Top	907 kg/2000lbs	6.45 kg/14.22lbs
BPC 0091310	63.5mm/2.5 Inch square tube jack	660mm/26 inches	Top	3175 kg/7000lbs	5.67 kg/12.5lbs
BPC 0091340	63.5mm/2.5 Inch square tube jack	660mm/26 inches	Side	3175 kg/7000lbs	5.67 kg/12.5lbs
BPC 0091405	114mm/4.5 Inch heavy duty square jack	304mm/12 inches screw travel plus 5 x 85mm increment adjustment	Side	5443 kg/12,000 lbs static 4536 kg/10,000lbs dynamic	27.22 kg/60lbs

OUR REPUTATION IS YOUR GUARANTEE

JOST
AUSTRALIA